

Multi- function Junction Box Fitting

MEASUREMENTS

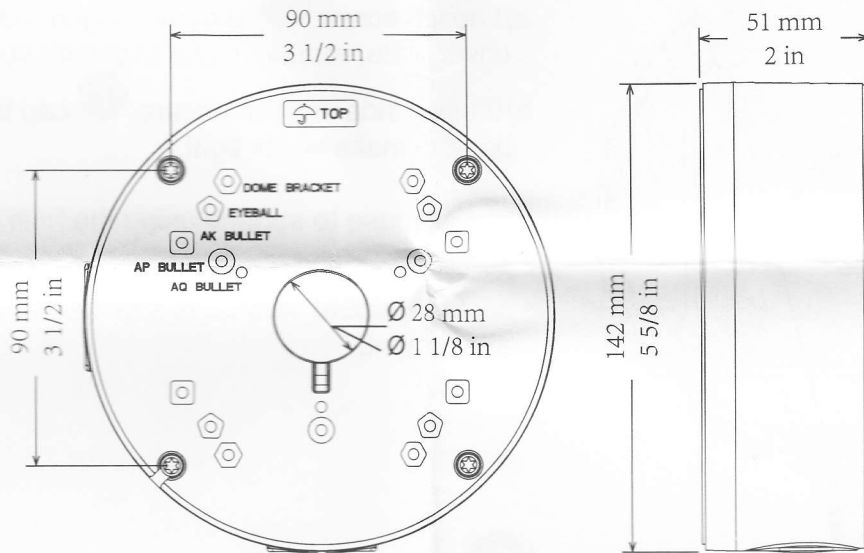

PRODUCT BREAKDOWN

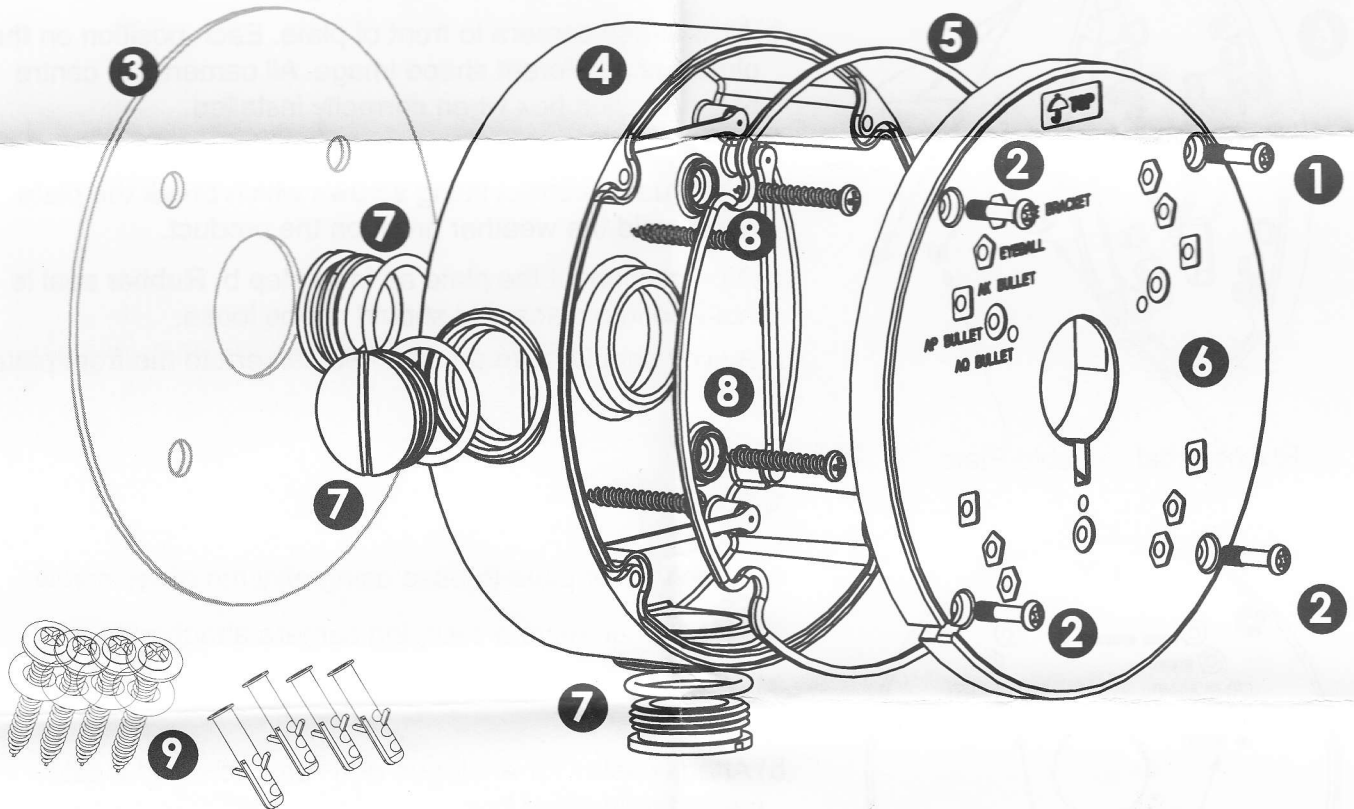

1 Hinge Screw
(Factory attached)

2 Fixing Screws
(Supplied 5pcs)

3 EVA Base Seal
(Supplied Fitted)

4 Base

5 Rubber Seal.
(Factory Glued in position)

6 Multi- Fitting Cover Plate

7 Conduit Seal Caps 3/4"-14 NPS
(Supplied installed)

8 Base Attachment Screws holes

INSTALLATION GUIDE

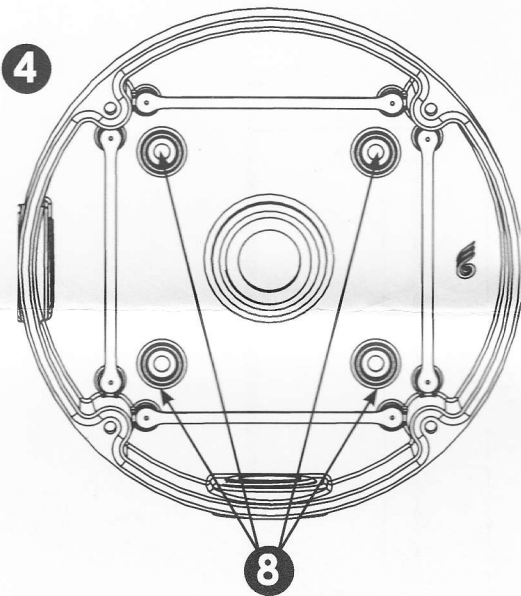

A

- Loosen screw **1** to allow hinged movement of the cover plate, remove plate and keep screw safe.
- If using side conduit ensure **7** cap is fitted to rear of base to make water tight.
- Attach base to surface using the hole positions as shown as **8**, use the four **9** screws and plugs supplied. Be sure the rubber washer is attached to assure waterproof attachment.

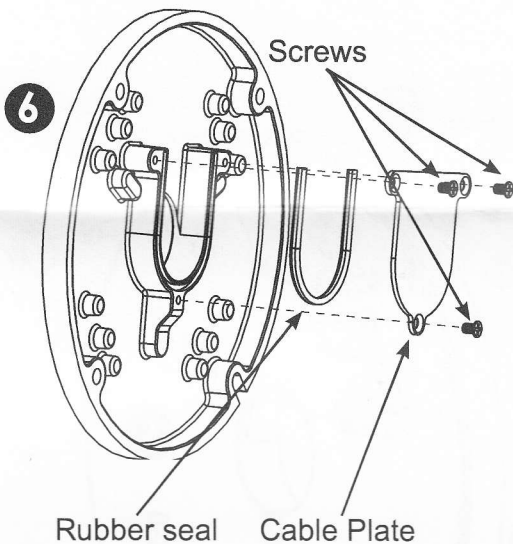

B

- Reverse side of cover plate **6** remove the three screws, to open front cable feed gap.
- Now attach camera to front of plate. Each position on the plate has a different shape image. All cameras fit centre of the junction box when correctly installed.

Note: The top of plate position is always to face north, do not try use incorrect fitting screws which break the plate as will void the weather proof on the product.

- Now reconnect the plate as from step b. Rubber seal is installed into place and should not be loose.

Now you should have an attached camera to the front plate

C

- Attach cover plate to base using only the hinge screw **1**. So can have a swinging camera attached to the junction box, to enable hands to connect cables.

- Attach cables for analogue or IP products and locate inside the junction box.

- Complete installation be sure rubber seal **5** is not pinched or damaged. Attach screws **2**. Into three location, be sure are tight. Note: 2 spares are provided

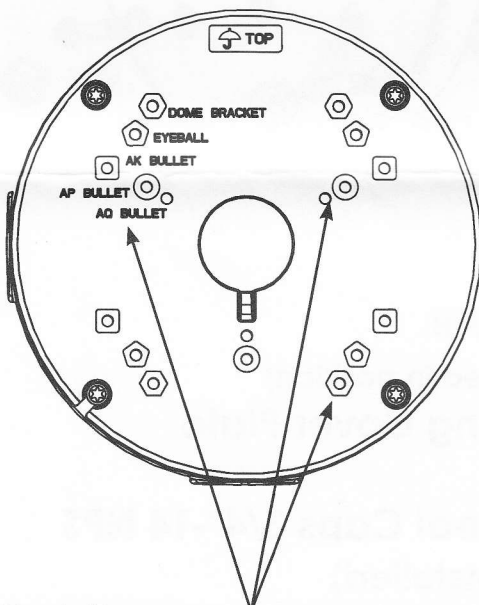

Note: Shapes match each model type